

STANDFAST KITCHEN KITS

HOW TO ASSEMBLE YOUR CORNER BASE MODULE

1. Assemble one unit at a time as you unpack it.
2. Insert cams into cam holes in Base, Backs and Sides, with screw side facing up.
3. Attach small Back to large Back as in diagram (1.) Make sure cams are facing out. Align parts and lock cams on each piece as you proceed by turning cam screws 180deg.
4. Attach Backs to Base then attach Sides to Back and Base as in diagram (2.) Align parts and lock cams on each piece as you proceed by turning cam screws 180deg. Make sure cams are facing out.
5. Fix small 45 x 20 Rail to larger Rail with black screws supplied, and then fix this unit to Corner Module as in diagram (3.)
6. For added support an adjustable leg (supplied) is required to be fixed to the rear corner of the Corner Module (with 35mm screws provided) as in diagram (4)
7. Now install your unit making sure it is level and square. (Corner Module should be the first Module installed)
8. Insert Shelf supports and place Shaped Shelf into position.
9. Insert 165deg hinges into Door/s and lock by turning screws ¼ turn clockwise. For bi-fold corner, insert and screw fix Blum Corner Hinge & mounting plate and clip together
10. Screw hinge-mounting plates to cabinet and clip on doors. Attach Handle/s.

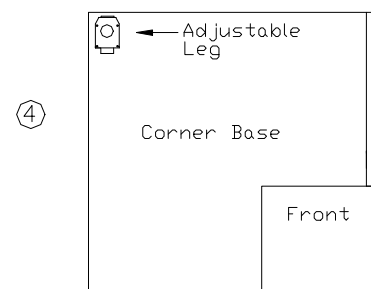
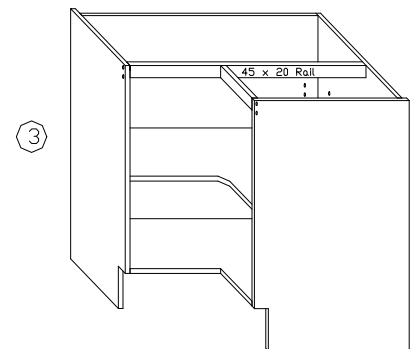
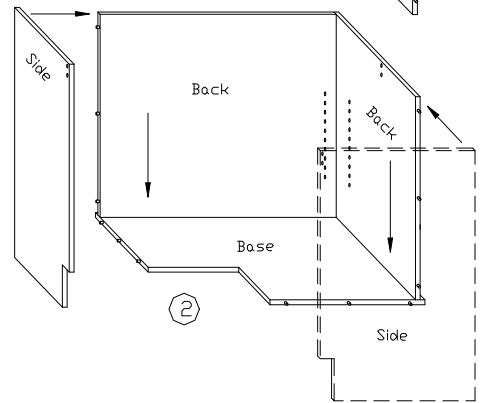
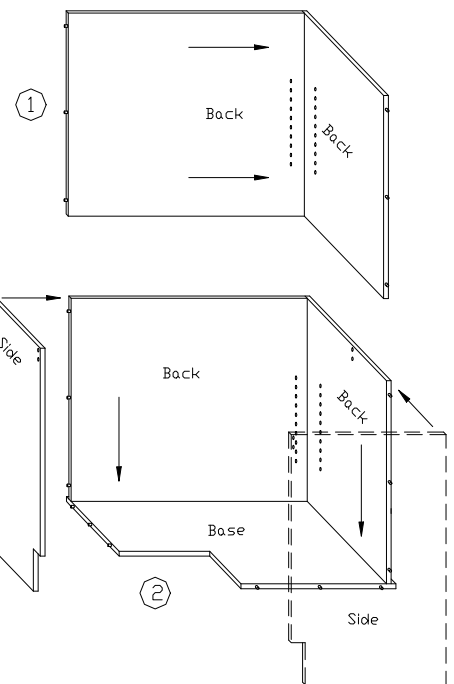
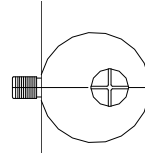

TOOLS REQUIRED
Spirit Level
Screwdriver (supplied)
Cordless drill